

REVISION HISTORY			
REV	DESCRIPTION	DATE	APPROVED
-	DCN 42574	08/16	DAL

# AAA T P - BBB - CCC

- CUT JACKET TO DIMENSION. DISREGARD IF SEMI RIGID IS USED
- TRIM BRAID/OUTER CONDUCTOR TO DIMENSION
- POINT CENTER CONDUCTOR (optional callout)
- TRIM DIELECTRIC FLUSH TO FERRULE FACE AFTER SOLDER (optional callout)
- TRIM CENTER CONDUCTOR TO DIMENSION

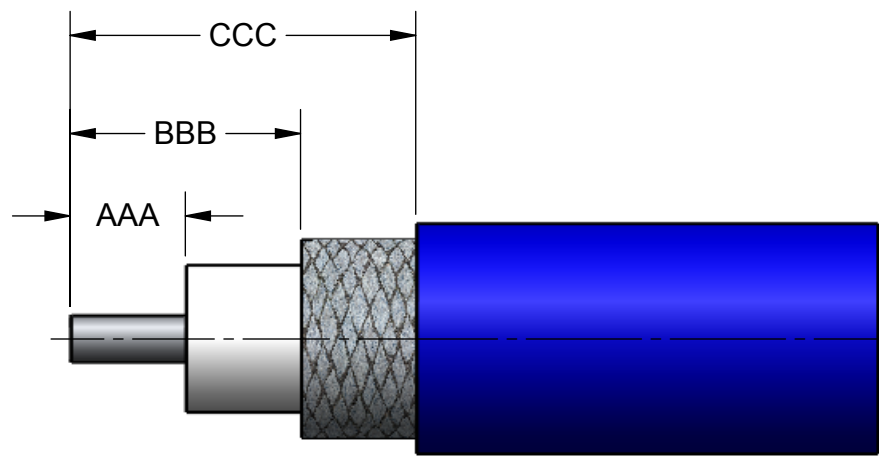

**AAA - BBB - CCC**

ex. 050 - 075 - 200

AAA = 050 = .050"  
 BBB = 075 = .075"  
 CCC = 200 = .200"

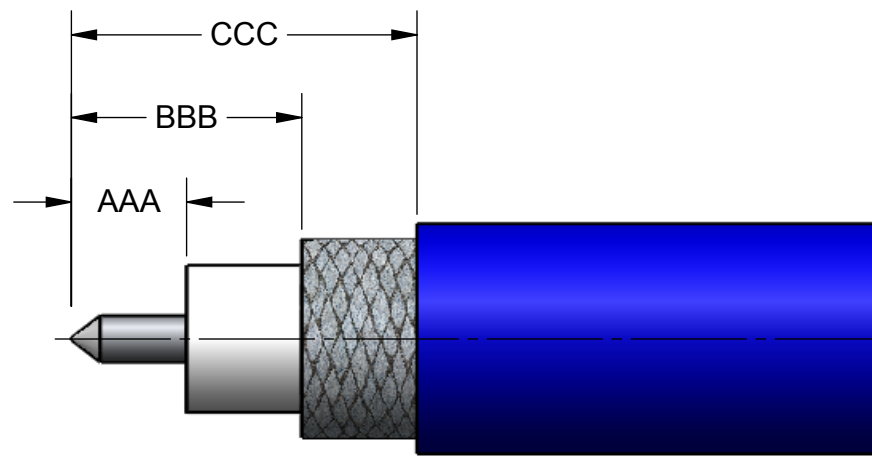

**AAAP - BBB - CCC**

ex. 060P - 080 - 250

AAA = 060 = .060"  
 BBB = 080 = .080"  
 CCC = 250 = .250"  
 P = POINTED CENTER CONDUCTOR

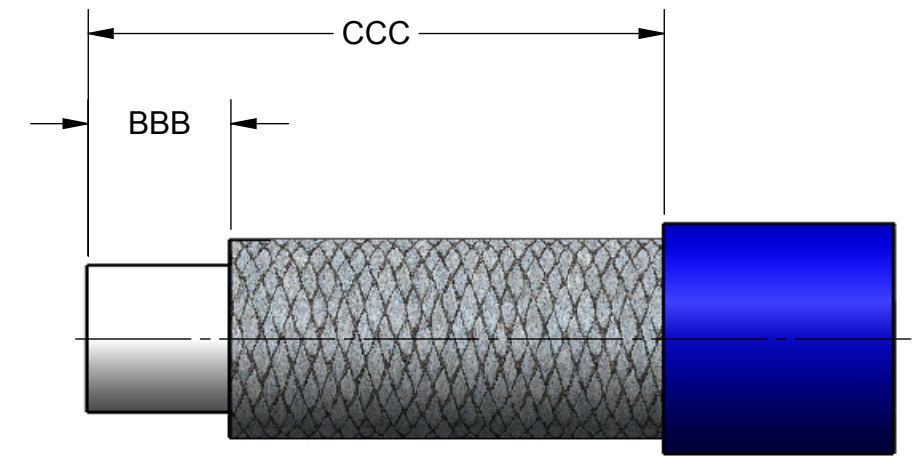

**AAAT - BBB - CCC**

ex. 000T - 060 - 300

AAA = 000 = .000"  
 BBB = 060 = .060"  
 CCC = 300 = .300"  
 T = TRIM DIELECTRIC FLUSH

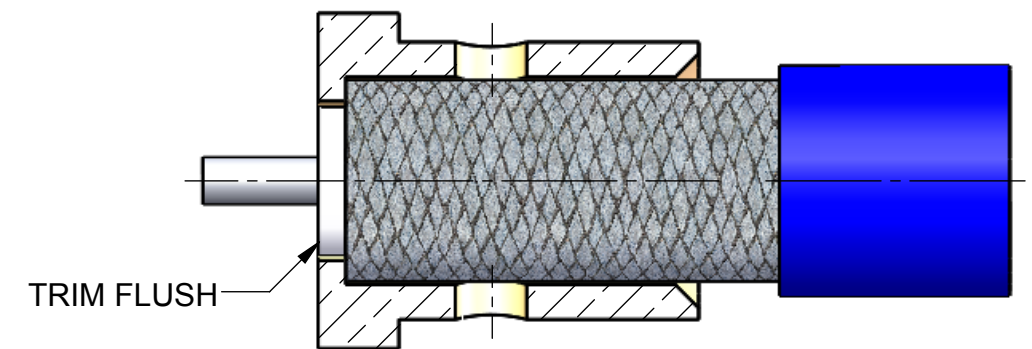

MATERIAL:	N/A
FINISH:	N/A
SURFACE AREA:	N/A
<b>PROPRIETARY</b>	
THE INFORMATION CONTAINED IN THIS DRAWING IS THE SOLE PROPERTY OF SV MICROWAVE, INC. ANY REPRODUCTION IN PART OR AS A WHOLE WITHOUT THE WRITTEN PERMISSION OF SV MICROWAVE, INC IS PROHIBITED.	

DIMENSIONS ARE IN INCHES TOLERANCES:	
FRACTIONAL: ±1/64	ANGULAR: X° ±1°0'
DECIMAL: X ±.030	X'X' ±15'
.XX ±.010	
.XXX ±.005	
INTERPRET DIMENSIONS AND TOLERANCES PER ASME Y14.5M - 1994	
THIRD ANGLE PROJECTION	

UNLESS OTHERWISE SPECIFIED	
1) ALL DIMENSIONS ARE AFTER PLATING.	
2) BREAK CORNERS & EDGES .005 R. MAX.	
3) CHAM. 1ST & LAST THREADS.	
4) SURFACE ROUGHNESS 63 / MIL-STD-10.	
5) DIA.'S ON COMMON CENTERS TO BE CONCENTRIC WITHIN .004 T.I.R.	
6) REMOVE ALL BURRS	
DRAWN:	ELA 07/14/16
CHECKED:	DAL 07/14/16
APPROVED:	DAL 07/14/16
E.M. SIMULATION:	N/A

2400 Centrepark West Drive, Suite 100 West Palm Beach, FL 33409	
TITLE: <b>CABLE ASSEMBLY INSTRUCTIONS TEMPLATE</b>	
SIZE: <b>B</b>	CAGE CODE: <b>95077</b>
DWG. NO.:	<b>400-05-112</b>
SCALE: 12:1	SHEET 1 OF 1

USED ON:	-
----------	---